

How to identify your specimen using the PlutoF Go app?

1. Open the PlutoF GO app and sign in.
2. Click: "Identify species" button.
3. Make a photo of your specimen by clicking the "Camera" button or upload an existing photo of your specimen by clicking the "Gallery" button. To learn how to make the best photo for fungal species identification, you can read the section *How to make informative photos?* on the [FunDive website](#).

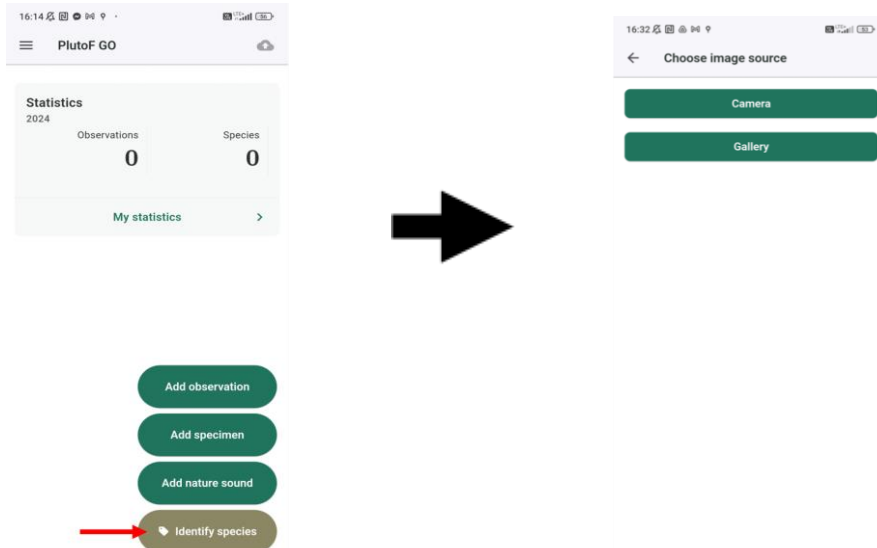

4. When you see that the photo is uploaded, click on the "Fungus" button. After a while you should see results with the best identification matches for your specimen. The percentage written on the right of each name suggests how certain the identification is.

